

FOR GENERAL AREAS ONLY
NOT FOR BIDDING OR CONSTRUCTION



STUDIO MELEE
1312 LOCUST STREET, SUITE 100Z
DES MOINES, IOWA 50309

(515) 493-0003
COPYRIGHT 2020

THESE DOCUMENTS ARE INSTRUMENTS OF PROFESSIONAL SERVICE AND SHALL REMAIN THE PROPERTY OF MELEE, LLC. THEY HAVE BEEN PREPARED SPECIFICALLY FOR THIS PROJECT AND SHALL NOT BE USED ON ANY OTHER PROJECTS OR IN ANY OTHER LOCATIONS WITHOUT OBTAINING THE PRIOR WRITTEN CONSENT OF MELEE, LLC. UNAUTHORIZED REPRODUCTION IS PROHIBITED.

FIRST FLOOR

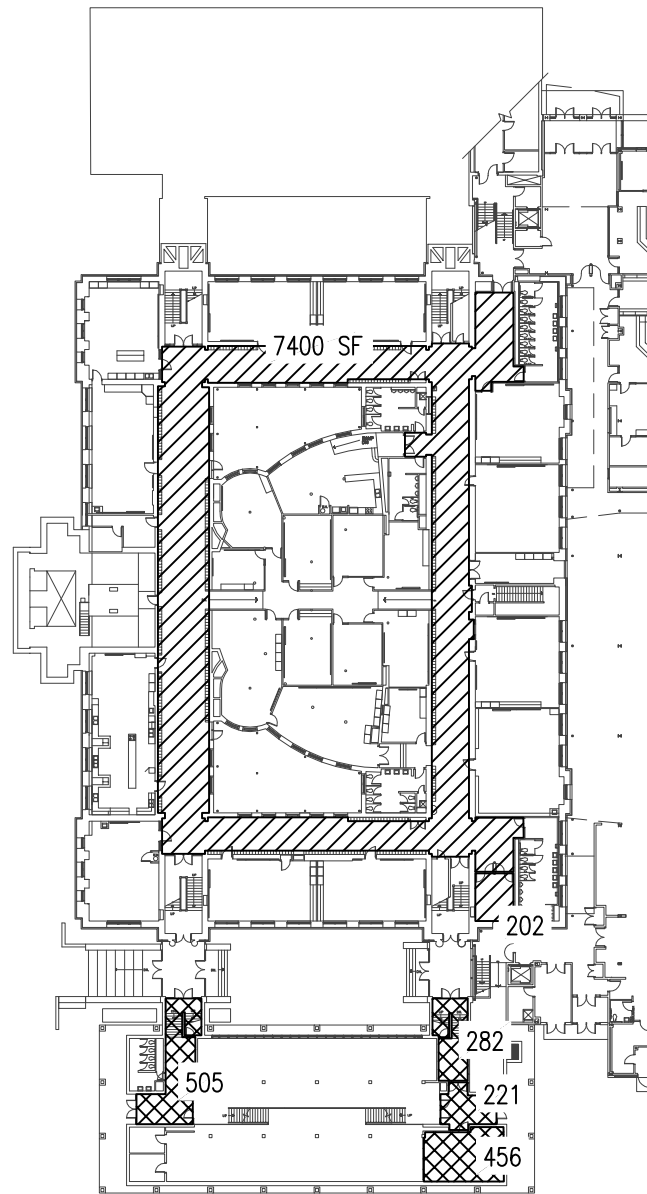

SECOND FLOOR

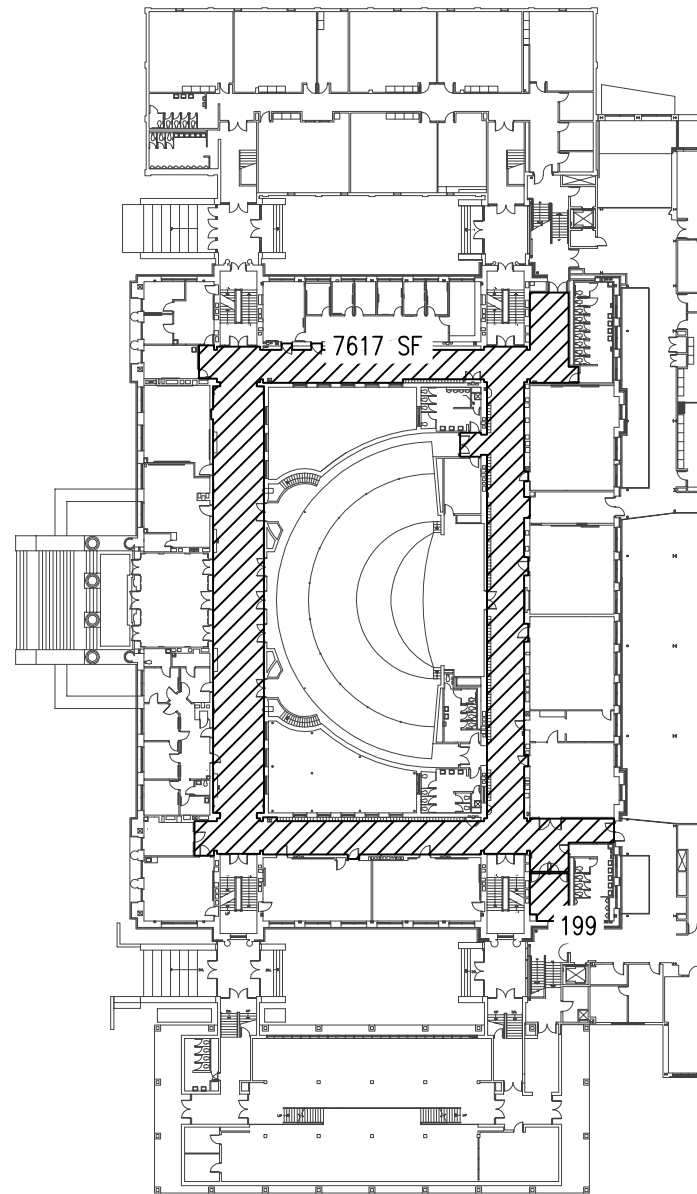

THIRD FLOOR

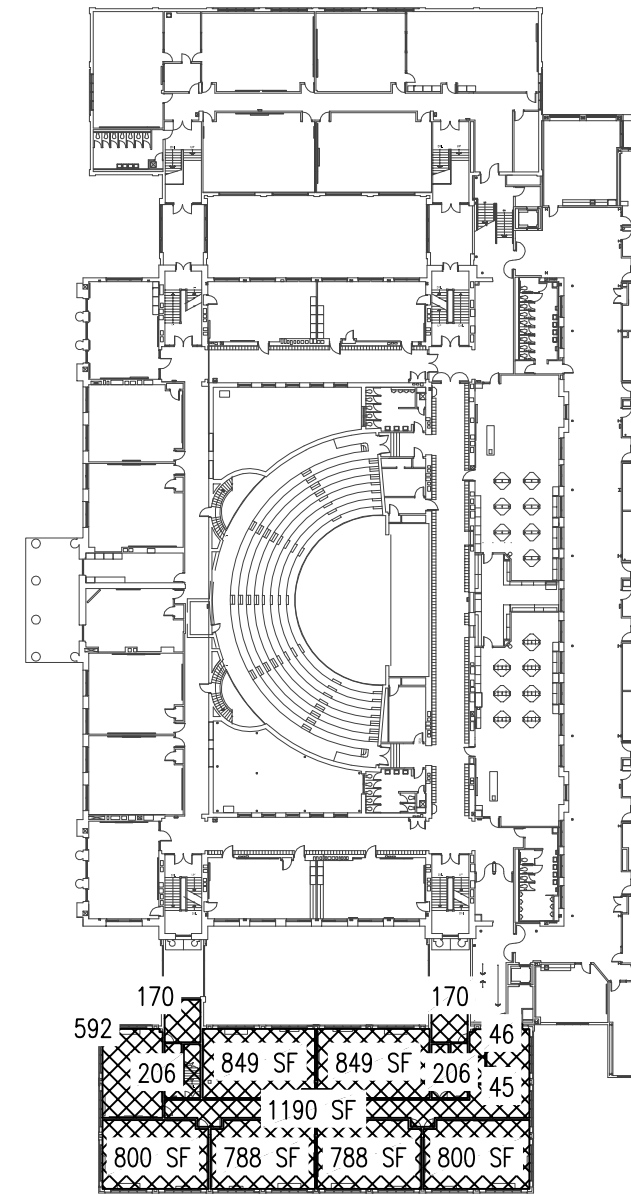

- 15,418 SF EXISTING TERRAZZO
REPLACED W/
NEW GROUND & POLISHED TERRAZZO
- 8,963 SF EXISTING 9X9 VCT (NEEDS ABATED)
REPLACED W/
NEW GROUND & POLISHED CONCRETE
- 24,831 SF TOTAL FLOOR REPLACEMENT AREA

FLOOR FINISH REPLACEMENT

GARTON, HANAWALT, CALLANAN, PROPOSED
WEEKS, NORTH AND EAST FLOOR AREAS

PRINT DATE:
DECEMBER 4TH, 2020

DES MOINES PUBLIC SCHOOLS

SCALE: 1/64" = 1'-0"

EAST HIGH SCHOOL

EAST